

# Haus B | «Casa Alberti» | 1. OG

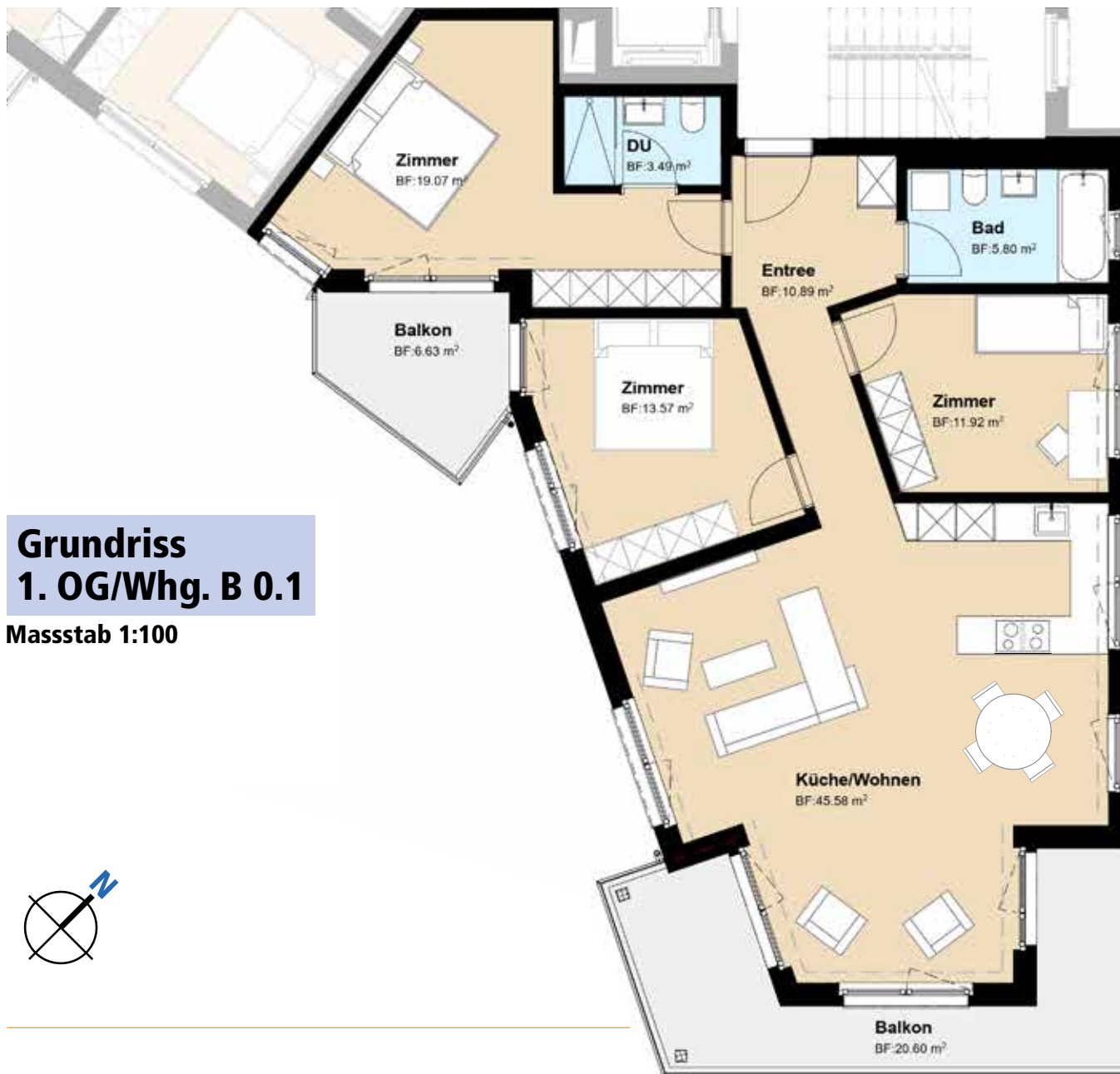

## Grundriss 1. OG/Whg. B 0.1

Masstab 1:100

## 4½-Zimmer-Whg. 110.32 m²

Entree	10.89 m²
Küche/Wohnen	45.58 m²
Zimmer	19.07 m²
Zimmer	13.57 m²
Zimmer	11.92 m²
Bad/WC	5.80 m²
Dusche/WC	3.49 m²
<b>Total</b>	<b>110.32 m²</b>

Balkon	20.60 m²
Balkon	6.63 m²
Keller	7.70 m²

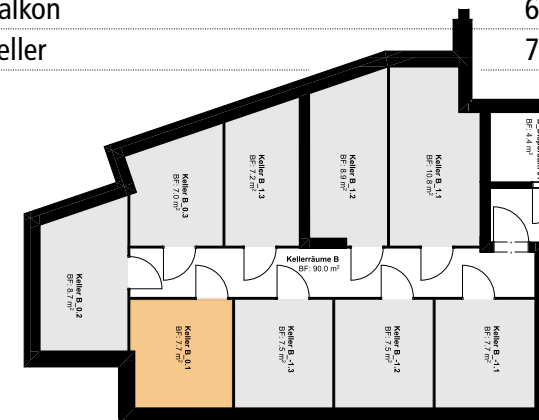

Whg. Nr. B 1.3	Whg. Nr. B 1.2	Whg. Nr. B 1.1
Whg. Nr. B 0.3	Whg. Nr. B 0.2	<b>Whg. Nr. B 0.1</b>
Whg. Nr. B -1.3	Whg. Nr. B -1.2	Whg. Nr. B -1.1
<b>Tiefgarage</b>		