

# III Haus B | «Casa Alberti» | 1. OG

## Grundriss 1. OG/Whg. B 0.2

Masstab 1:100



## 4½-Zimmer-Whg. 106.00 m<sup>2</sup>

Entree	12.66 m <sup>2</sup>
Küche/Wohnen	43.21 m <sup>2</sup>
Zimmer	15.92 m <sup>2</sup>
Zimmer	13.74 m <sup>2</sup>
Zimmer	11.42 m <sup>2</sup>
Bad/WC	5.33 m <sup>2</sup>
Dusche/WC	3.72 m <sup>2</sup>
	<b>106.00 m<sup>2</sup></b>

Balkon	13.50 m <sup>2</sup>
Keller	8.70 m <sup>2</sup>

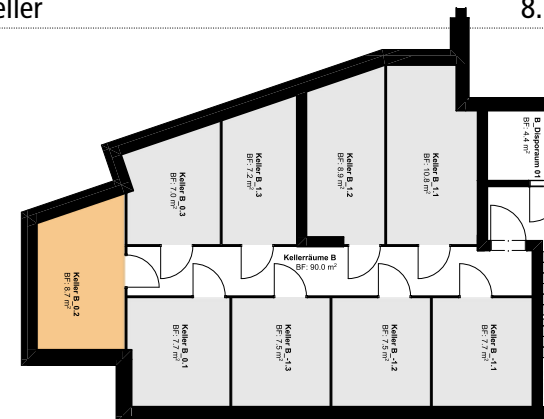

Whg. Nr. B 2.3	Whg. Nr. B 2.2	Whg. Nr. B 1.1
Whg. Nr. B 0.3	<b>Whg. Nr. B 0.2</b>	Whg. Nr. B 0.1
Whg. Nr. B -1.3	Whg. Nr. B -1.2	Whg. Nr. B -1.1
<b>Tiefgarage</b>		